

STREAMLINED, AUTOMATED BENCHMARKING



AUTOMATE PORTFOLIO MANAGER SCORING FOR IMPROVED ENERGY AWARENESS.

For utilities seeking to provide greater customer service by lowering barriers for building owners and managers, MyMeter's Benchmarking tool provides streamlined, automated benchmarking capabilities, along with automated tenant data aggregation authorization request and approval processing. The user-friendly platform integrates seamlessly with ENERGY STAR® Portfolio Manager® and utility Customer Information Systems to automatically update and track energy efficiency scoring for commercial and multi-family facilities.

FAST AND ACCURATE BENCHMARKING.

MyMeter's Benchmarking tool helps improve awareness of energy-saving opportunities, drives participation in utility programs, and supports adherence to city and state ordinances. Building managers and owners are better informed and empowered to compare their electric, gas, and water consumption with a regularly updated score, ranking their performance in comparison to peer buildings.

- Establish a baseline score and track improvements.
- Automatic efficiency score updates.
- Integrate multiple meters with ENERGY STAR Portfolio Manager.
- Identify relative energy usage property portfolios.
- Reduce human error and time spent on manual data entry.
- Uncover energy reduction opportunities and see results and impacts.
- Compare performance with similar properties in the service area.

DYNAMIC REPORTING. DYNAMITE RESULTS.

MyMeter's Benchmarking tool links directly to ENERGY STAR Portfolio Manager via secure web services to send energy use information (including considerations for building end-use attributes, such as: operating hours, occupancy or floor area) to provide a weather-normalized percentile ranking of 1 (low efficiency) to 100 (high efficiency). Benchmark enhances ENERGY STAR's usability to provide valuable, hassle-free feedback on your customers' energy usage.

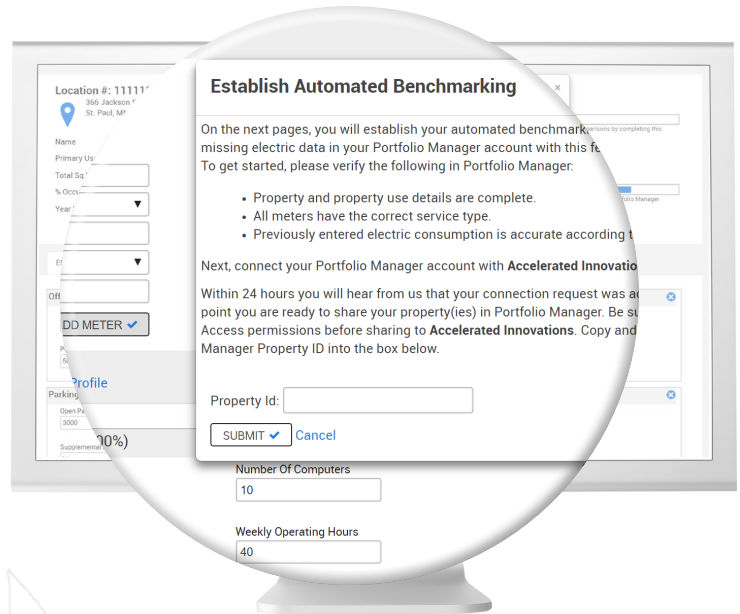

IDEAL FOR COMMERCIAL AND PUBLIC FACILITY USE, INCLUDING:

| | | | |
|---------|-----------|--------------|----------|
| Schools | Retail | Multi-family | Parking |
| Offices | Hospitals | Warehouses | Churches |

INCREASED ENGAGEMENT. INCREASED IMPACT.

MyMeter's Benchmarking tool provides large and small customers with the ability to make absolute and relative comparisons of their progress and extends your reach to those who can benefit most from ongoing efficiency programs.

- 🔗 Automate the aggregation of monthly energy use data to a whole-building level.
- 🔗 Identify targets for energy audits, rebates and other promotions with direct messaging and property profile modules.
- 🔗 Generate leads by identifying qualified participants for new utility program offerings.
- 🔗 Facilitate provider/consumer interaction and suggest energy efficiency recommendations.
- 🔗 Streamline functionality and increase association for services already in use.
- 🔗 Enhance service with compatibility with MyMeter for complete AMI/AMR data reporting and analytics.
- 🔗 Optional consent management process to support compliance with data aggregation threshold policies.

